

BV-132DT三片式不銹鋼螺紋球閥

產品特徵：

SPECIFICATIONS

- *公稱壓力：1/4" ~2" PN140 bar
Working Pressure: 1/4" ~2" 2000PSI
- *適用溫度範圍：-20 ~ 180°C
Temperature Range: -20 ~ 180°C
- *連接形式：內螺紋
End Types: Female Threaded
- *掛鎖裝置 Locking Device
- *ISO5211直接安裝執行器機構平臺設計
ISO5211 Direct-Mounting of Actuators of Valves Design
- *防爆中軸設計，防靜電裝置
Blow-Out Proof Stem Design, Antistatic Device
- *精密鑄造 Investment Casting



型號：BV-132DT

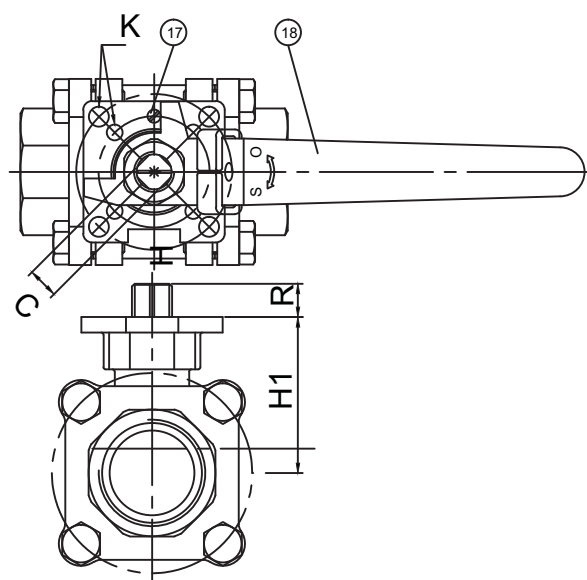
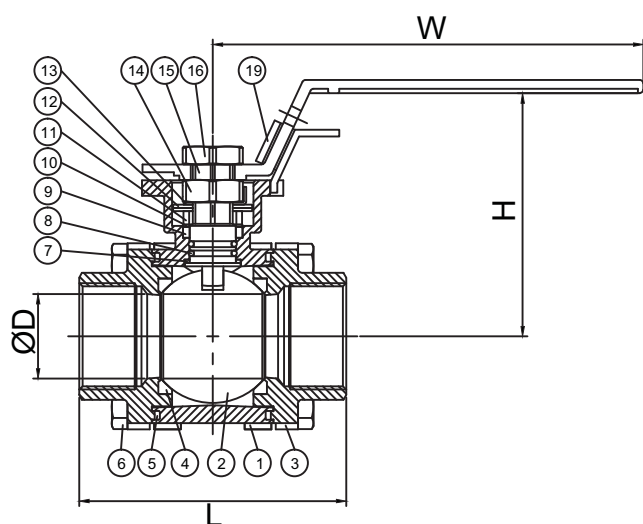

MATERIAL LIST

NO.	DESCRIPTION	QTY	MATERIAL	
1	BODY	1	ASTM-A351-CF8M	ASTM-A216-WCB
2	BALL	1	ASTM-A351-CF8M	ASTM-A351-CF8
3	CAP	2	ASTM-A351-CF8M	ASTM-A216-WCB
4	SEAT	2	TFM1600	TFM1600
5	JOINT GASKET	2	VITON	VITON
6	BOLT	4	SUS 304	SUS 304
7	THRUST WASHER	1	TFM1600	TFM1600
8	O-RING	2	VITON	VITON
9	STEM PACKING	1	TFM1600	TFM1600
10	THRUST WASHER	1	PTFE 15%	PTFE 15%
11	GLAND BUSH	1	SUS 304	SUS 304
12	BELLEVILLE WASHER	2	SUS 301	SUS 301
13	STOP WASHER	1	SUS 304	SUS 304
14	STEM NUT	1	SUS 304	SUS 304
15	STEM	1	SUS 316	SUS 304
16	HANDLE NUT	1	SUS 304	SUS 304
17	STOP PIN	1	SUS 304	SUS 304
18	HANDLE	1	CF20	CF20

DIMENSION

Unit : mm

SIZE	C	ØD	H	H1	K	L	R	W
1/4"	9	11	73	36	F03/F04	75	9	111
3/8"	9	12.5	73	36	F03/F04	75	9	111
1/2"	9	15	73	36	F03/F04	75	9	111
3/4"	9	20	78	41	F03/F04	80	9	111
1"	11	25	87.5	49.5	F04/F05	90	11	186
1-1/4"	11	32	94	56	F04/F05	110	11	186
1-1/2"	14	38	109	70	F05/F07	120	14	197
2"	14	50	117	78	F05/F07	140	14	197